

ELEVATION

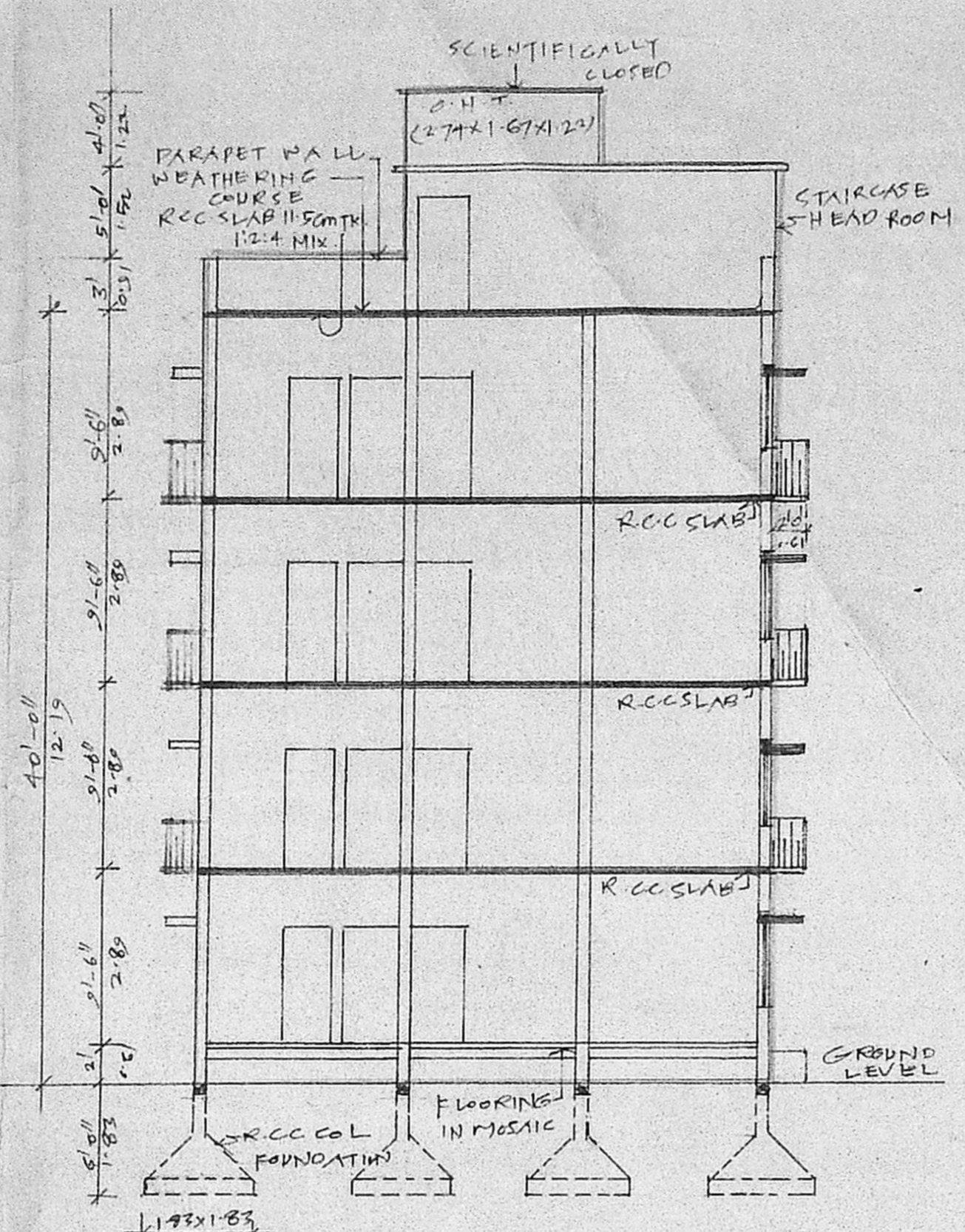

As per the elevation "A-A"
 of DP/B in P. 11 & 12 this
 OK Sanctioned Plan is
 signed by AP @ 220590.
 01/02/90 216/90 5190

Planning Permit No. 381.61
APPROVED
 SUBJECT TO THE CONDITIONS IN
 THIS OFFICE LETTER.
 01/02/90
 Date: 01/02/90
 For Member Secretary
 MADRAS METROPOLITAN
 DEVELOPMENT AUTHORITY
 ANNAMALAI ROAD
 CHENNAI 600 002

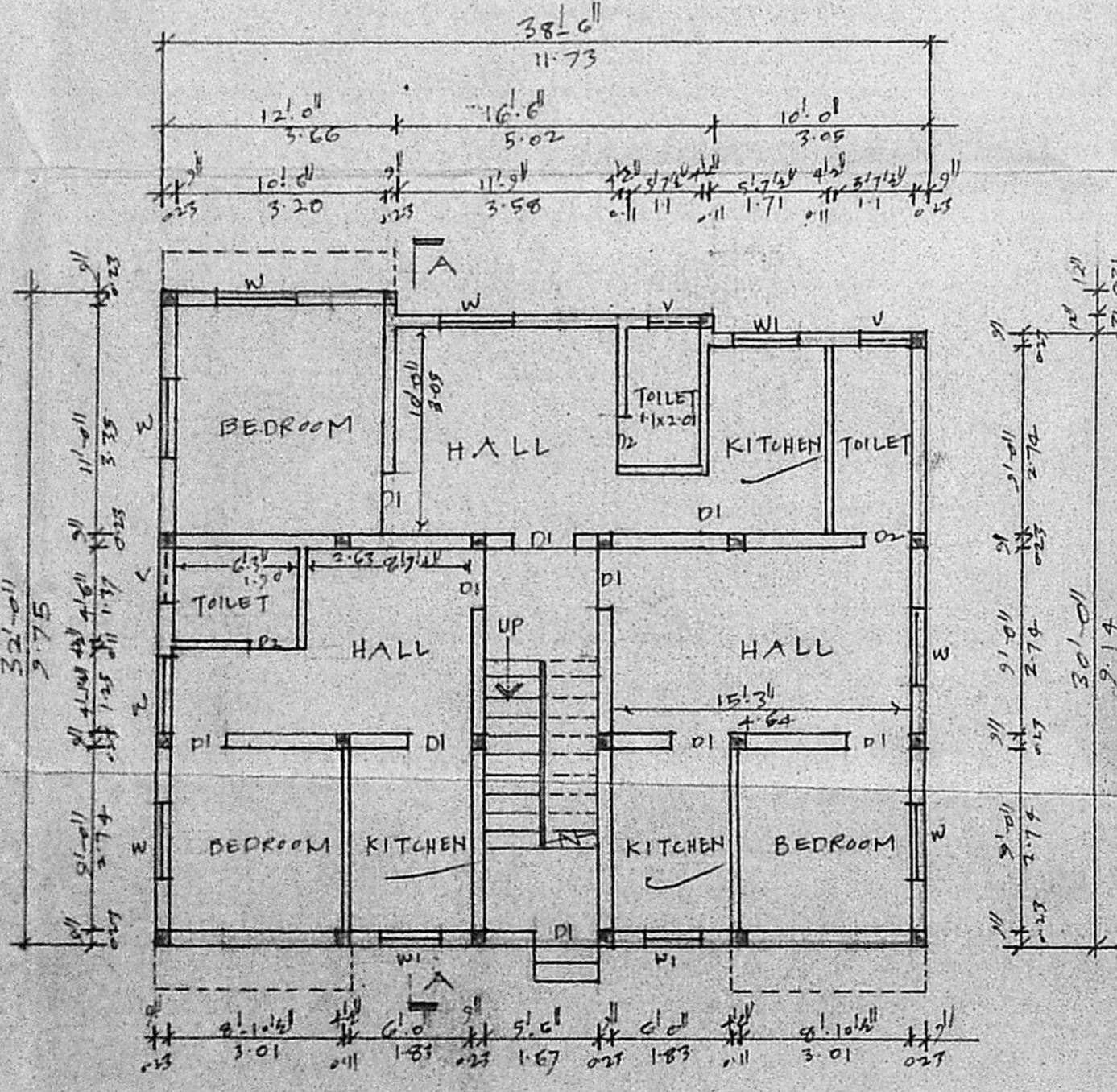

GROUND FLOOR PLAN

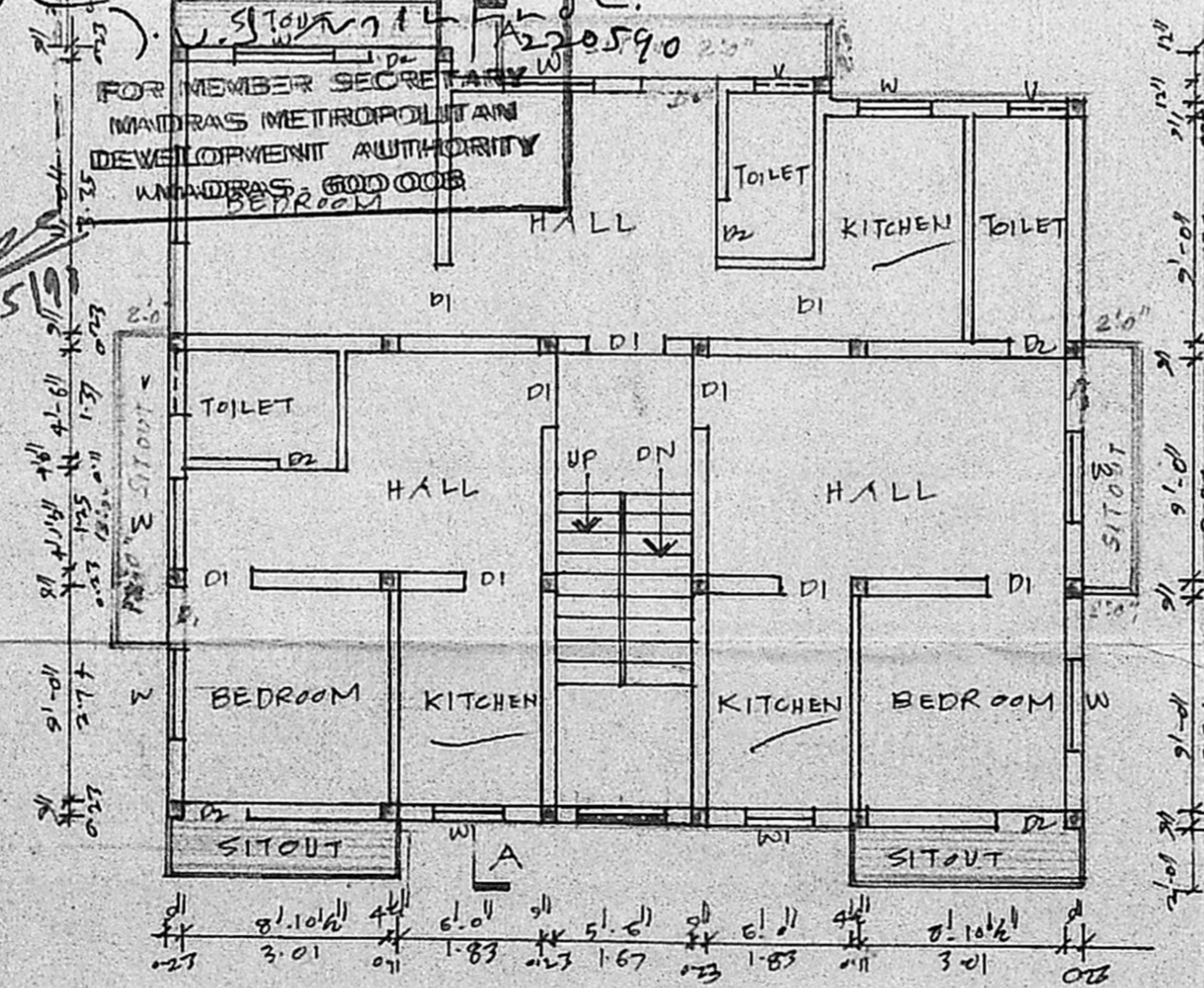

TYPICAL FIRST SECOND AND THIRD FLOOR PLAN

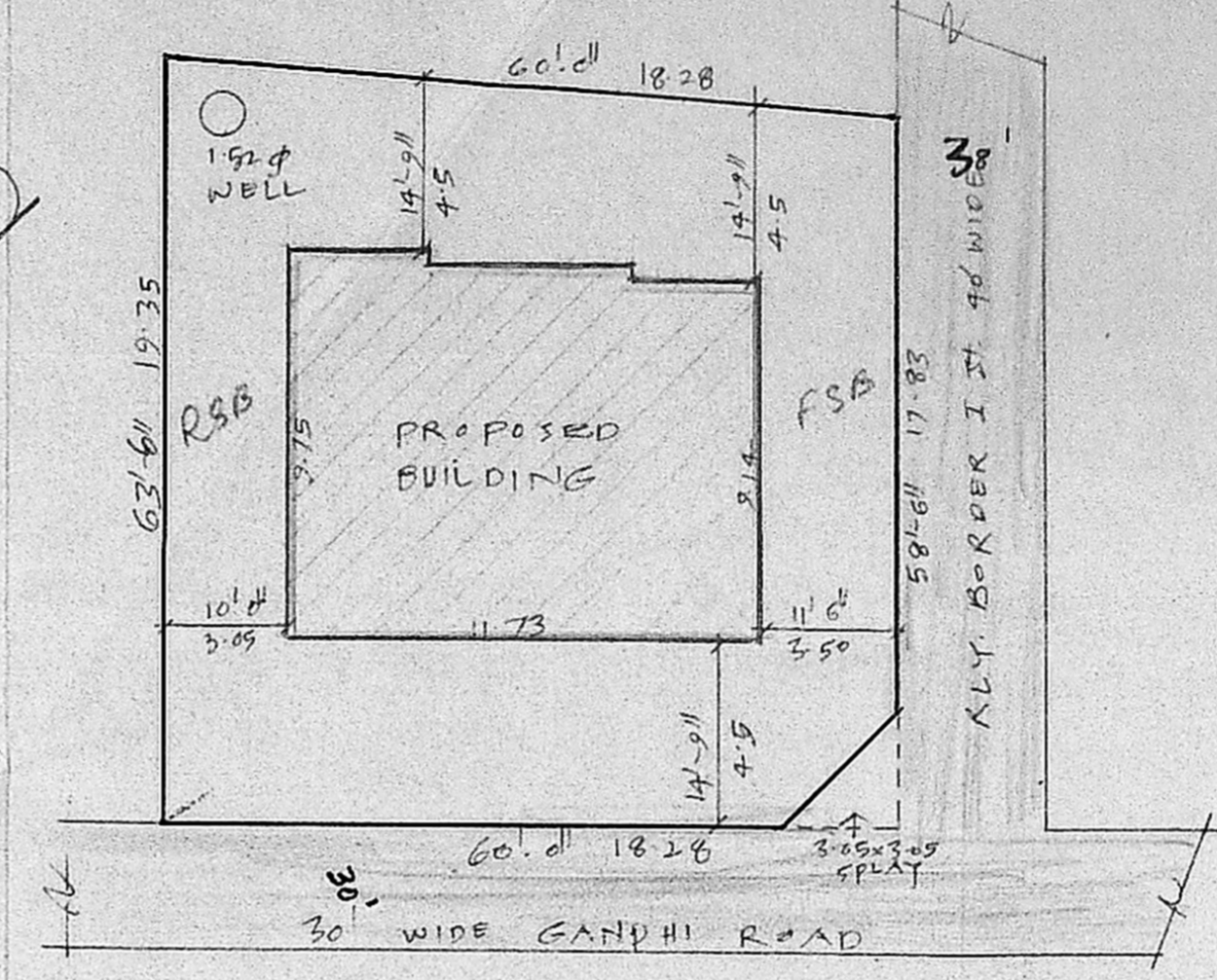

SITE PLAN
 SCALE 1:200

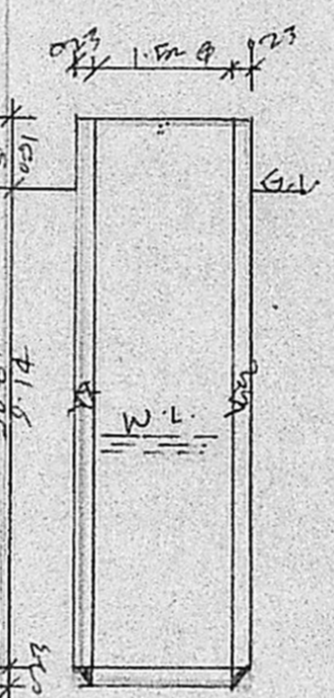

DETAIL OF WELL

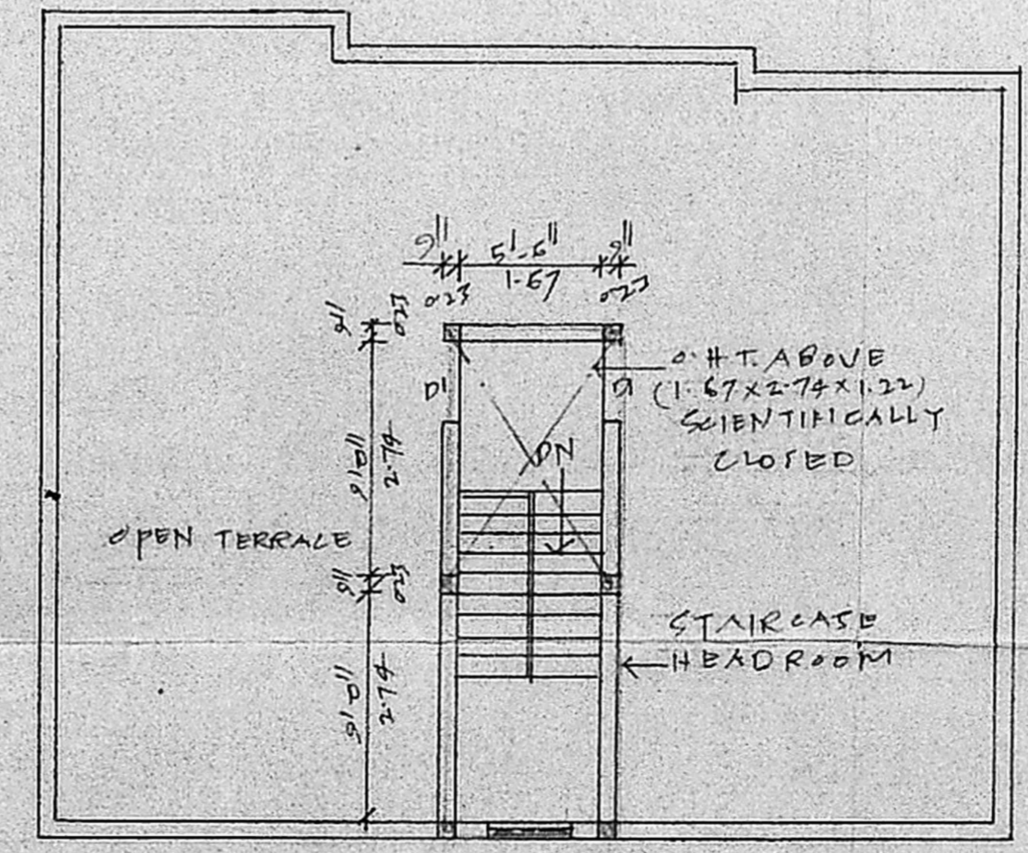

TERRACED FLOOR PLAN

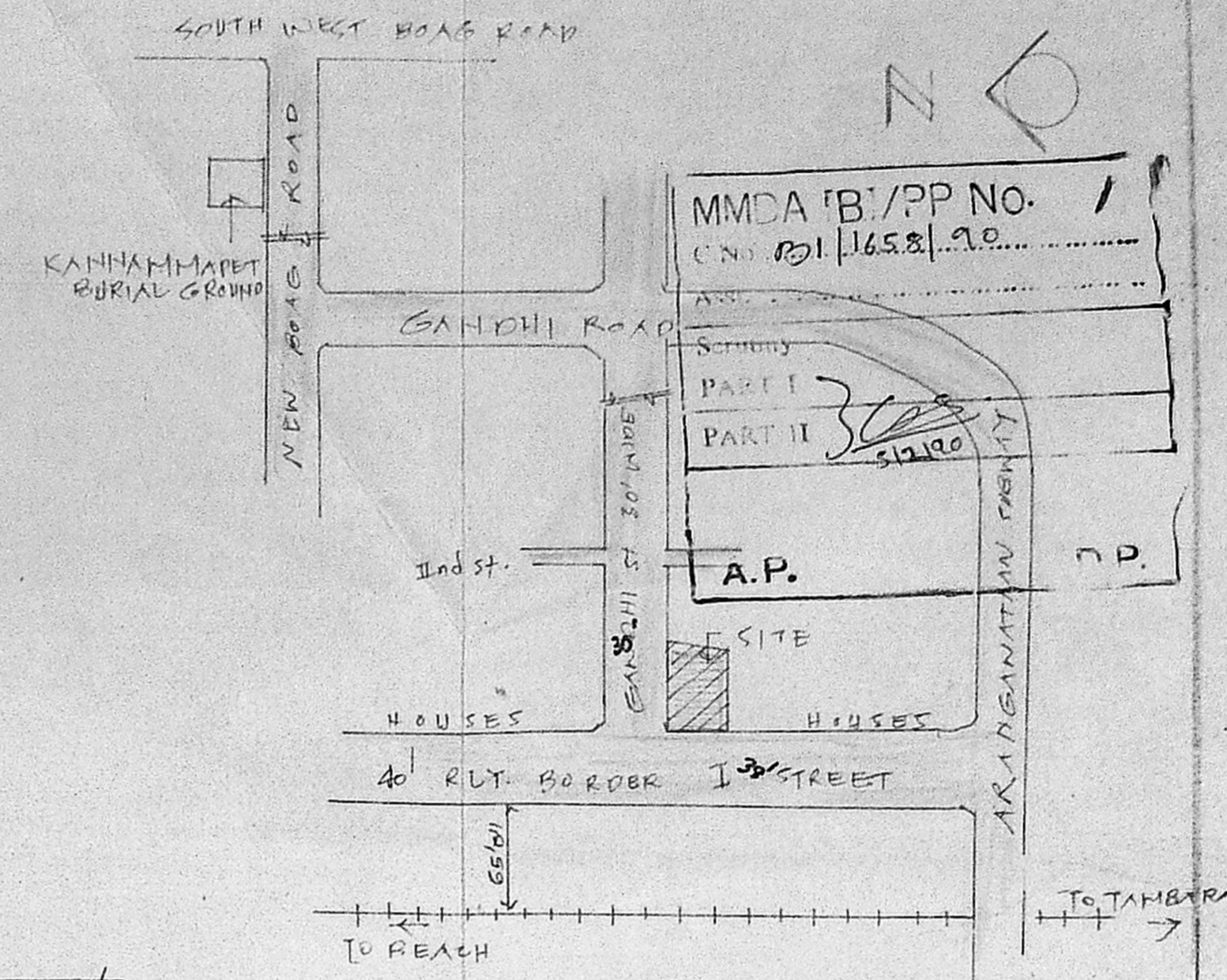

KEY PLAN
 NOT TO SCALE

JOINERY DETAILS:-			
D1 DOOR	0.91 x 2.00	W1 WINDOW	1.06 x 1.37
D2 DOOR	0.76 x 2.00	V VENTILATOR	0.76 x 0.61
W WINDOW	1.22 x 1.37		

AREA STATEMENT	SQ. FT.	SQ. M.
PLOT EXTENT	3643	335.52
GROUND FLOOR	1155	107.34
FIRST FLOOR	1215	112.91
SECOND FLOOR	1215	112.91
THIRD FLOOR	1215	112.91

PLAN SHOWING THE
 PROPOSED RESIDENTIAL FLATS
 AT Plot Nos 14 & 15/1, T. No 2 & 3/1
 RLY. BORDER I ST STREET & GANDHI ST.,
 MAMBALAM, BLOCK No 30, MADRAS.
 SCALE (1" = 81'-0") 1:100

SIG. OF OWNER: *[Signature]*
 SIG. OF LICENSED SURVEYOR:
K. VENUGOPAL
 A.E.E. (Rtd)
 CONSULTING CIVIL ENGINEER
 LICENSE SURVEYOR CLASS
 CORPORATION OF MADRAS
 3, NEELAKANDAN STREET
 NINGAMBARKKAM (LARE AREA)
 MADRAS 600 034